



DIGITRON

DIGISIGN LED VIDEOTRON

Introducing DIGITRON, an LED Display by InnoGRAPH with a remarkable design from QSTECH and CVTE's research. Its simplified implementation, easy installation, and lower total cost of ownership (TCO) make it the ideal choice. We deliver total solutions for a successful and stress-free project.



digit **sign**

powered by:
QSTECH
CVTE technology

Pain Points of Traditional LED Videotron (Electrical & Mechanical)

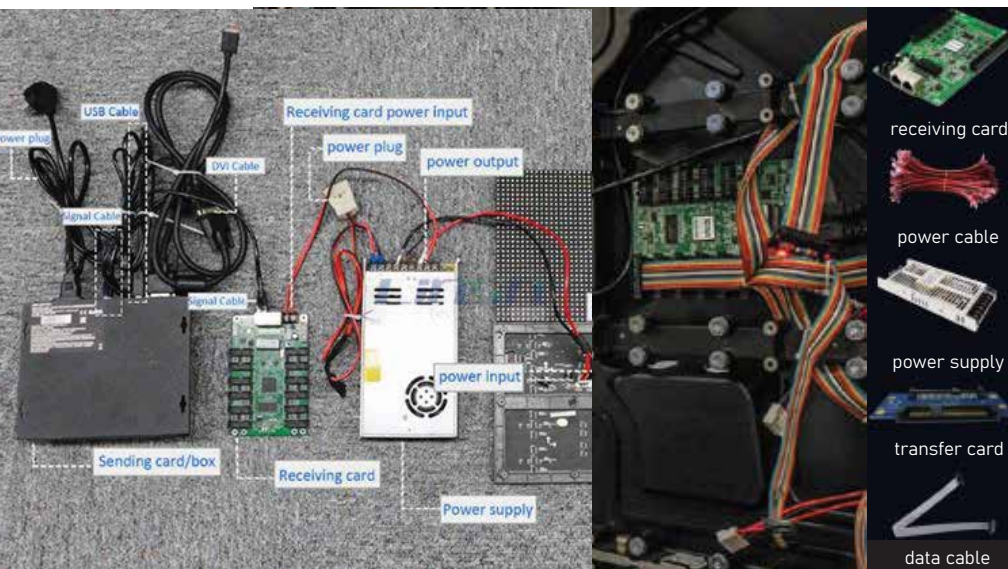

- Complicated component
 - Module
 - Cabinet
 - Receiving Card
 - Sending box
 - Power Supply
 - etc
- Need skilled engineer
- Complicated installation
 - Blank Videotron
 - Unplugged cable

DIGITRON PRO SOLUTION

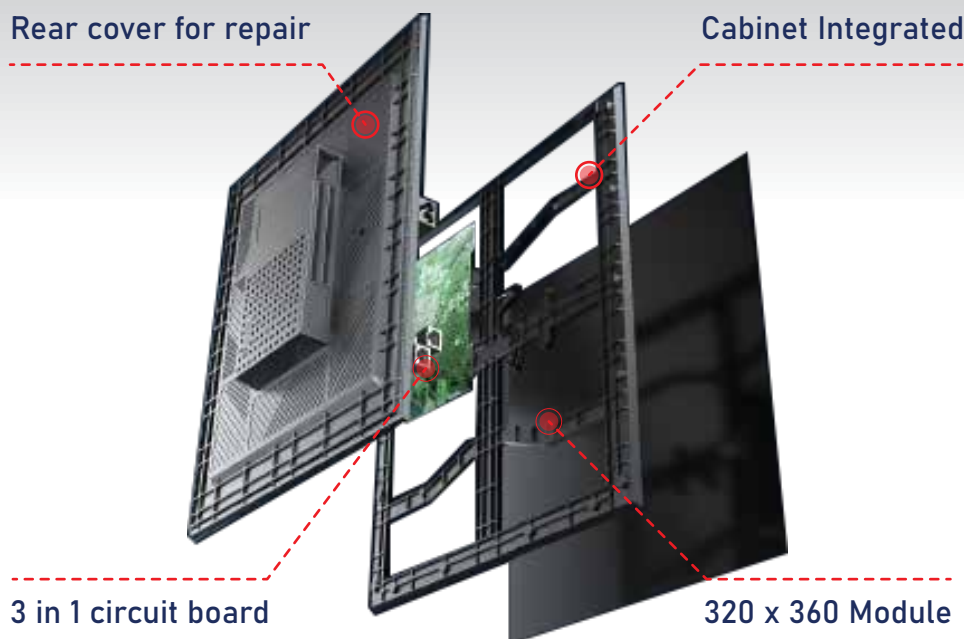

- Less Device, Cabling & Simple Mechanical
 - Easy to Install
 - Reliable
 - Lower Cost
 - Easy Maintenance
- Cabinet Integrated
 - Cover
 - Electrical
 - Panel Module
- Flat & 45 degree installation
- Single Board replace
 - Power supply
 - Receiving Card
 - Power Cable
- Simple Cabling
 - RJ-45
 - Power Cable AC 220V

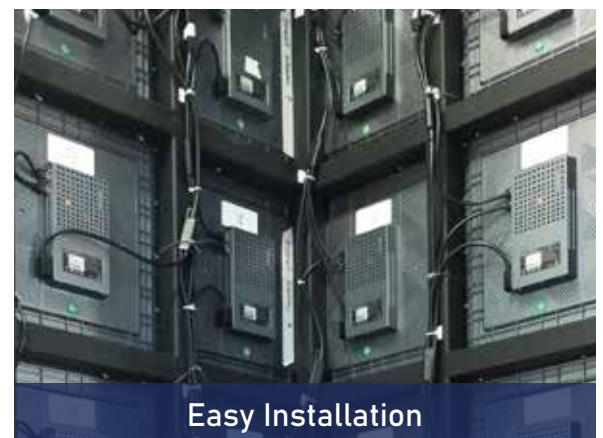
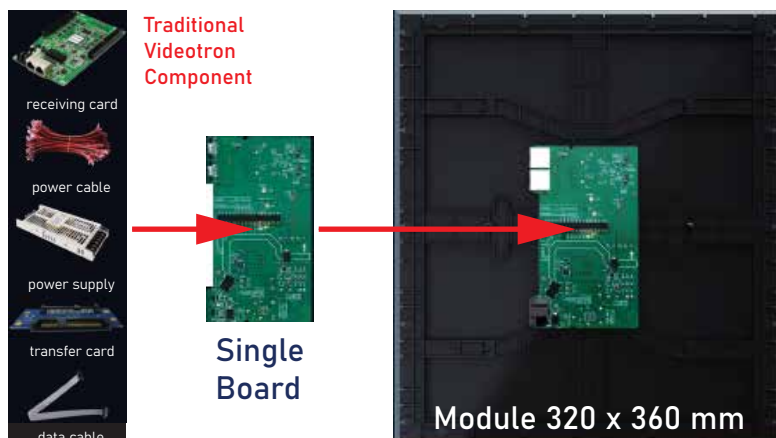

Application Scenario-Multiple Modes. Meet multiple creative display needs, 45 degree corner, available in 320 x 360 mm module

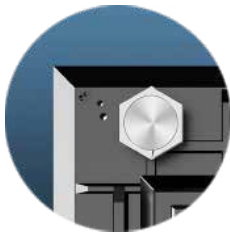
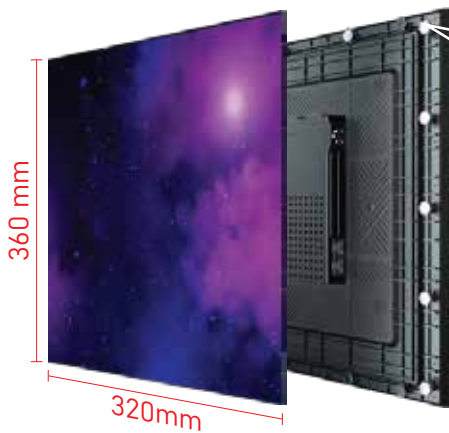

Magnetic Front - Installation

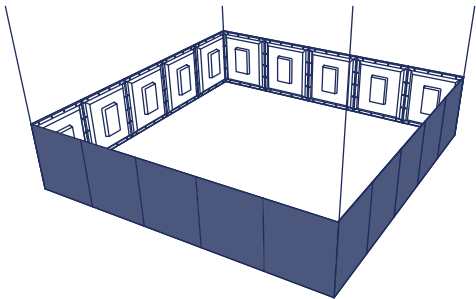

Hanging

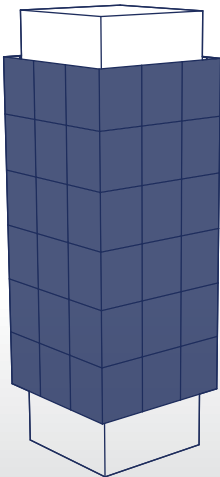

Pillar

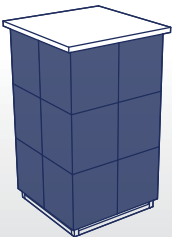

Desk

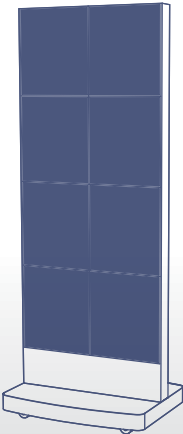

Floorstand Vertical Banner

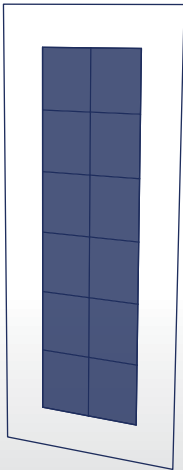

Store Fascia

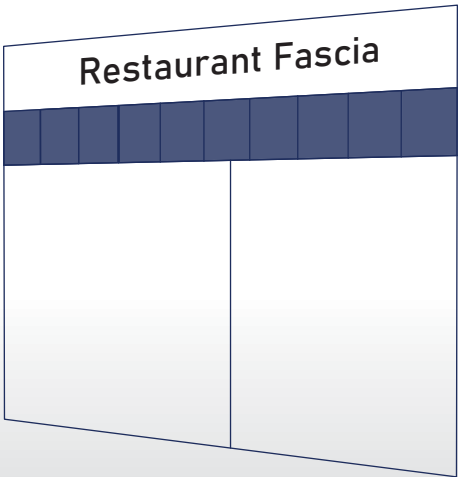

Convenient for operation

- Local storage
- Remote control
- Wireless projection
- Control via small screen
- Analog touch pad
- Custom time switch



Product Parameter

PRODUCT MODEL	DIGITRON PRO P1.8	DIGITRON PRO P2.5
Pixel Pitch	1.8	2.5
Resolution	171 * 192	128 * 144
Maximum Power Cons	295W/m ²	
Cabinet Size	320 * 360 * 39	
Cabinet Weight	1.16 Kg	
Contrast	6500 : 1	
Brightness	500 nits	600 nits
Viewing Angle	117°/H, 170 °/V	
LEDs Life Time	≥100.000 h	
Maintenance Mode	Front	

Subscribe and setup in minutes • Easy manage multi brand screen (Android, Tizen, WebOS, Windows) • Hassle-free setup • Real cloud system with Security & Backup system • Streamline & detail User Management • Enhanced Device Management tools • Powerful Data-Set View Configuration • Detailed Reporting (device, proof of play, bandwidth, layout, media)

Single Display

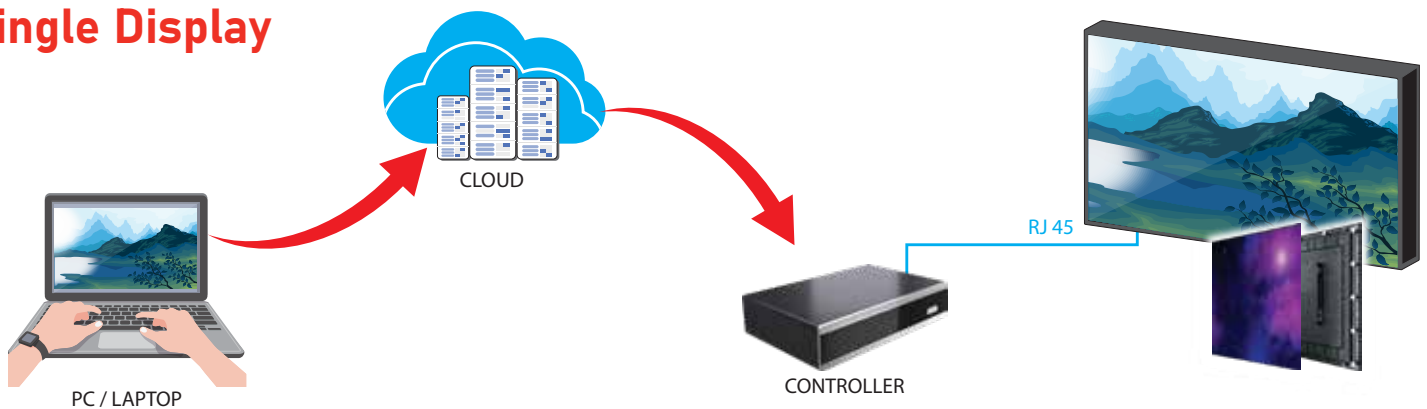

Multiple Display

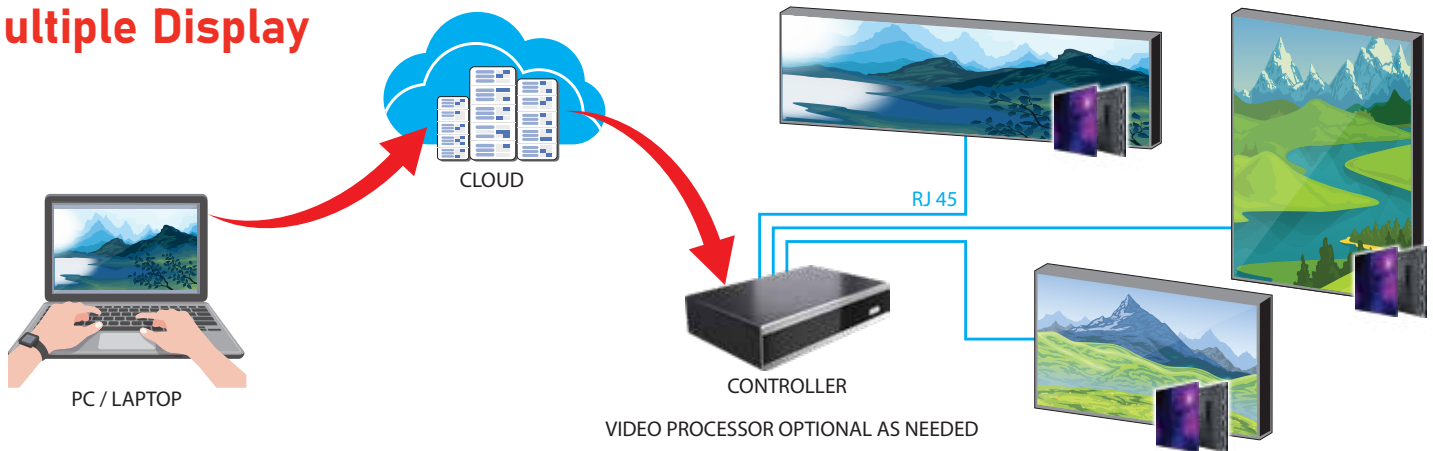

Enterprise Display Ecosystem

